

**Telescopic  
Fusion+ 60 cm  
Transparent**



EAN 5414425007806

### Energy label

▪ Energy Efficiency class (EEIhood)	A+
▪ Annual Energy Consumption (kWh/year) (AEChood)	28,3
▪ Fluid Dynamic Efficiency class (FDEhood)	A
▪ Lighting Efficiency class (LEhood)	A
▪ Grease Filtering Efficiency class (GFEhood)	C

### Functions & features

▪ Control method	Touch control
▪ Number of speeds	3 + power
▪ Automatic Power revert (minutes)	6
▪ Motor	Integrated
▪ Sound absorber	Integrated
▪ Recirculation	Optional
▪ InTouch function	Optional
▪ Auto stop	▪
▪ Delayed switch off (minutes)	10
▪ Number of grease filters	2
▪ Grease filter	780020
▪ Grease filter cleaning indication	▪
▪ Recirculation filter cleaning indication	▪

### Dimensions

▪ Product dimensions (WxDxH) (mm)	599 x 340 x 368
▪ Dimensions cut-out opening (WxD) (mm)	x
▪ Min dimensions cabinet (WxDxH) (mm)	600 x 340 x
▪ Advised mounting height induction hobs (Hmin-Hmax) (mm)	500 - 750
▪ Advised mounting height gas hobs (Hmin-Hmax) (mm)	650 - 750
▪ Advised mounting height ceramic hobs (Hmin-Hmax) (mm)	500 - 750
▪ Diameter outlet (mm)	150
▪ Position exhaust	Top

### Lighting

▪ Functional lighting type	Led strip
▪ Dimmable light	-
▪ Soft-ON/OFF	-
▪ Total energy consumption functional light (W)	8
▪ Color functional light	3000

### Airflow and noise level

▪ Airflow (m <sup>3</sup> /h) measured according to EN 61591	
▪ Sound regulation according to EN 60704-2-13	
▪ Airflow speed 1 (m <sup>3</sup> /h) / Max Pressure speed 1 (Pa)	257 / 69

## Airflow and noise level

---

▪ Airflow speed 2 (m <sup>3</sup> /h) / Max Pressure speed 2 (Pa)	463 / 237
▪ Airflow speed 3 (m <sup>3</sup> /h) / Max Pressure speed 3 (Pa)	620 / 372
▪ Airflow Powerspeed (m <sup>3</sup> /h) / Max Pressure Powerspeed (Pa)	716 / 372
▪ Sound pressure speed 1 (dB(A)) / Sound power speed 1 (dB(A))	29 / 39
▪ Sound pressure speed 2 (dB(A)) / Sound power speed 2 (dB(A))	41 / 52
▪ Sound pressure speed 3 (dB(A)) / Sound power speed 3 (dB(A))	48 / 58
▪ Sound pressure Powerspeed (dB(A)) / Sound Powerspeed (dB(A))	51 / 61

## Technical specifications

---

▪ Maximum power	115
▪ Voltage (V)	220-230
▪ Frequency (Hz)	50
▪ Length power supply cord (m)	1,2
▪ Power consumption in stand-by-mode (Ps) (W)	0.29
▪ Net weight (kg)	11

1

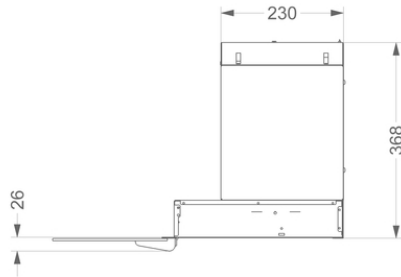

2

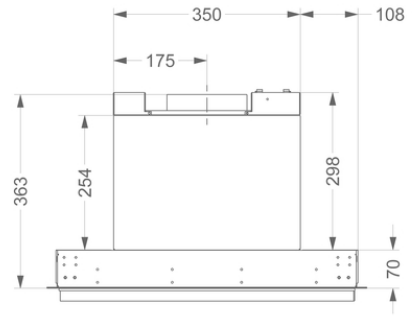

3

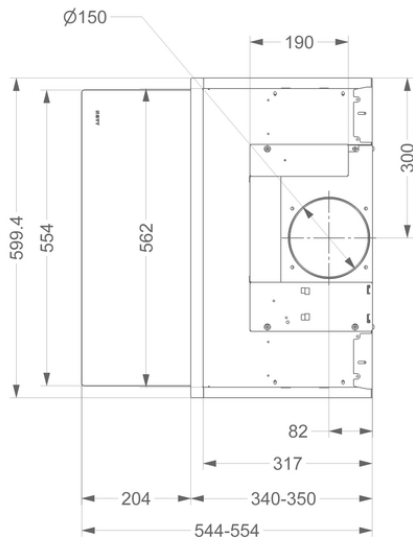

4

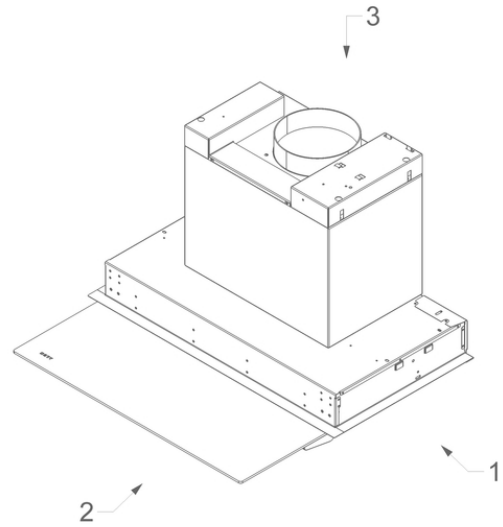

**Accessories**

---

**Recirculation kit**

680400

Monoblock recirculation set Fusion, Fusion+

Efficiency Curve

